

KEYNOTES

- 3.09 RECESS SLAB AS NECESSARY TO MAINTAIN AN ACCESSIBLE THRESHOLD CONDITION
5.03 5 1/2" COMPOSITE MTL DECK AND CONCRETE SLAB
5.05 6" METAL TRACK
5.06 6" METAL STUD FRAMING
5.07 STRUCTURAL STEEL FRAMING
5.09 3 5/8" METAL STUD FRAMING
5.10 3 5/8" METAL TRACK
5.54 BRAKE METAL TRIM
5.55 UNIVERSAL BYPASS STEEL CLIP
6.02 WOOD BLOCKING
7.05 MCM PANEL SOFFIT
7.06 BATT INSULATION, SIZED TO MATCH STUD DEPTH
7.08 AWB
7.09 MINERAL FIBER BOARD INSULATION
7.11 2 1/2" POLYISO INSULATION
7.12 2 1/2" POLYISO INSULATION
7.13 2 PLY SBS ROOFING SYSTEM
7.24 ROOF DRAINAGE MAT
7.32 GRAVEL STOP FASCIA
7.36 MCM PANEL
7.38 SELF-ADHERED FLASHING
7.39 TRANSITION MEMBRANE
7.44 WOOD PAVER TILES; SEE LANDSCAPE FOR TILE LAYOUT PATTERN
7.55 ADJUSTABLE PEDESTALS
8.01 ALUM STOREFRONT, CURTAINWALL, OR WINDOW SYSTEM; SEE OPENING SCHEDULE
8.09 BACK PANEL
9.01 5/8" GYPSUM BOARD; SEE FINISH PLAN FOR FINISH MATERIAL
9.04 5/8" EXTERIOR SHEATHING
22.01 TRENCH DRAIN - CONNECT TO PLUMBING

CONSULTANTS
Monsieur & Associates, LLC
CABLO Landscape Architecture, LLC
Fox Nease Engineering, Inc.
Sela O'Brien
Mechanical Engineering
Associated Design Group, Inc.
Electrical Engineering
Specialty Architecture

ASHE I BROUSSARD I WEINZETTLE
ARCHITECTS

TIPTON
ASSOCIATES

ISSUE FOR BID
LOUISIANA STATE UNIVERSITY
ALEXANDRIA
DOWNTOWN HEALTH SERVICES CENTER
800 JACKSON ST.
ALEXANDRIA, LA 71301

PROJECT # 19-602-23-01
ARCH PROJECT # 2023.20 / 1031.00-23
SITE ID: NEW SITE CODE: 4-40-023
DATE OCTOBER 10, 2023

Ashe Broussard Weinzeitz Architects, LLP
Tipton Associates APAC, A Joint Venture
301 Jackson Street, Suite 205
Alexandria, LA 71301

NO. REVISION DATE

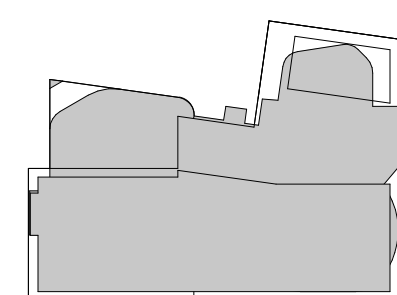
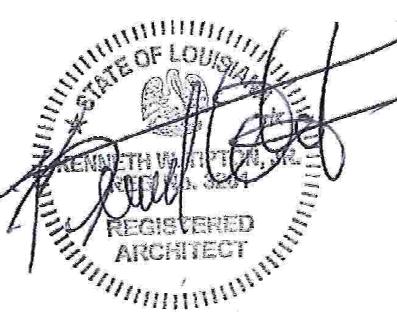
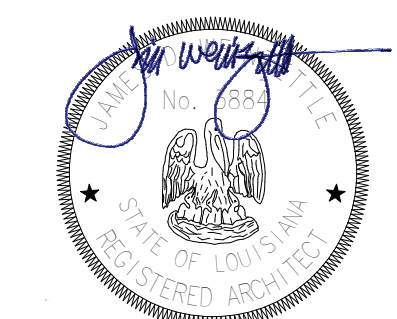

4 SOFFIT DETAIL
3" = 1'-0" | RE:2/A350

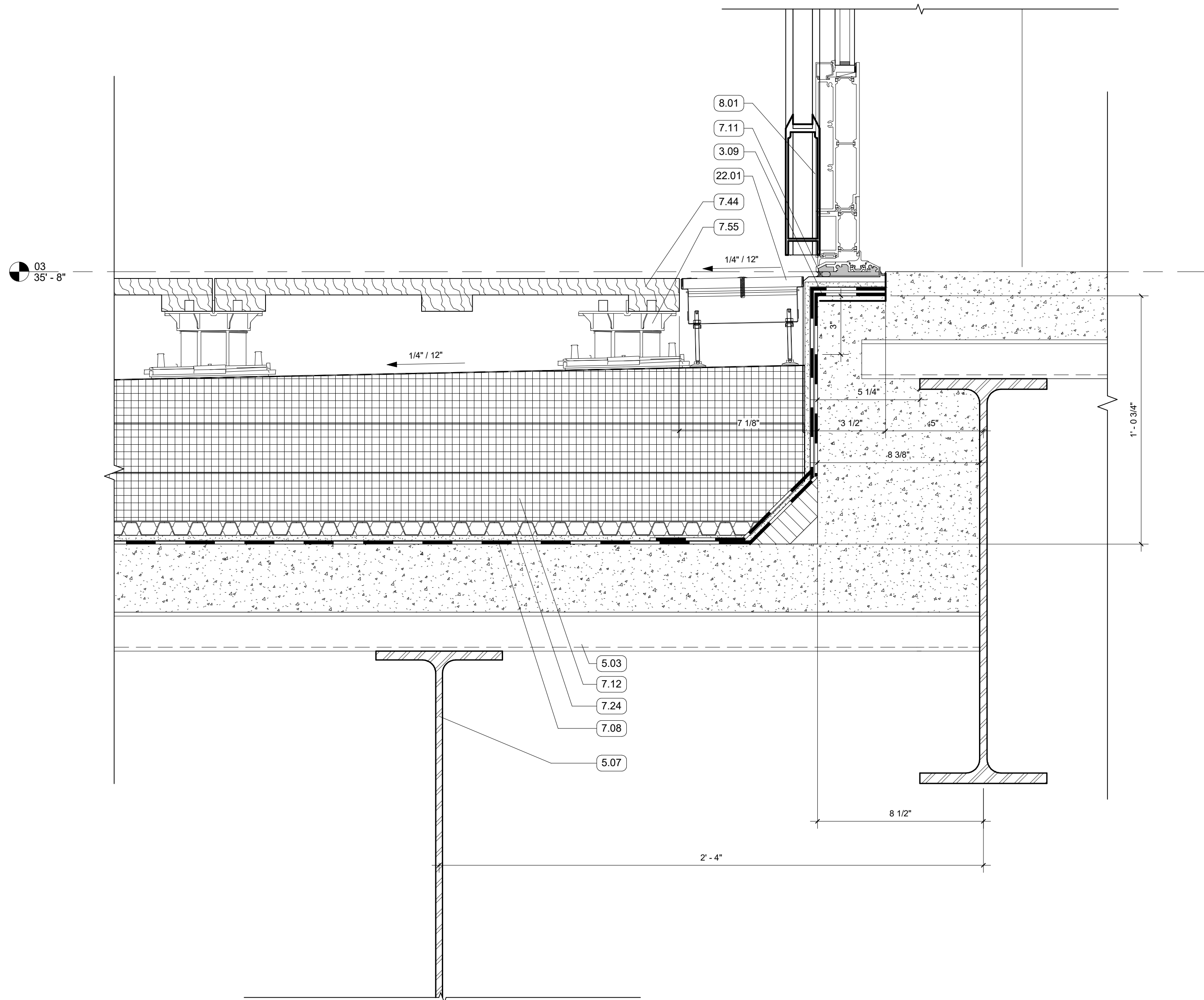

1 ROOF DETAIL
3" = 1'-0" | RE:1/A103

19-602-23-01

2 SOUTH THROUGH VESTIBULE UPPER - Callout 3
3" = 1'-0" | RE:3/A351

19-602-23-01

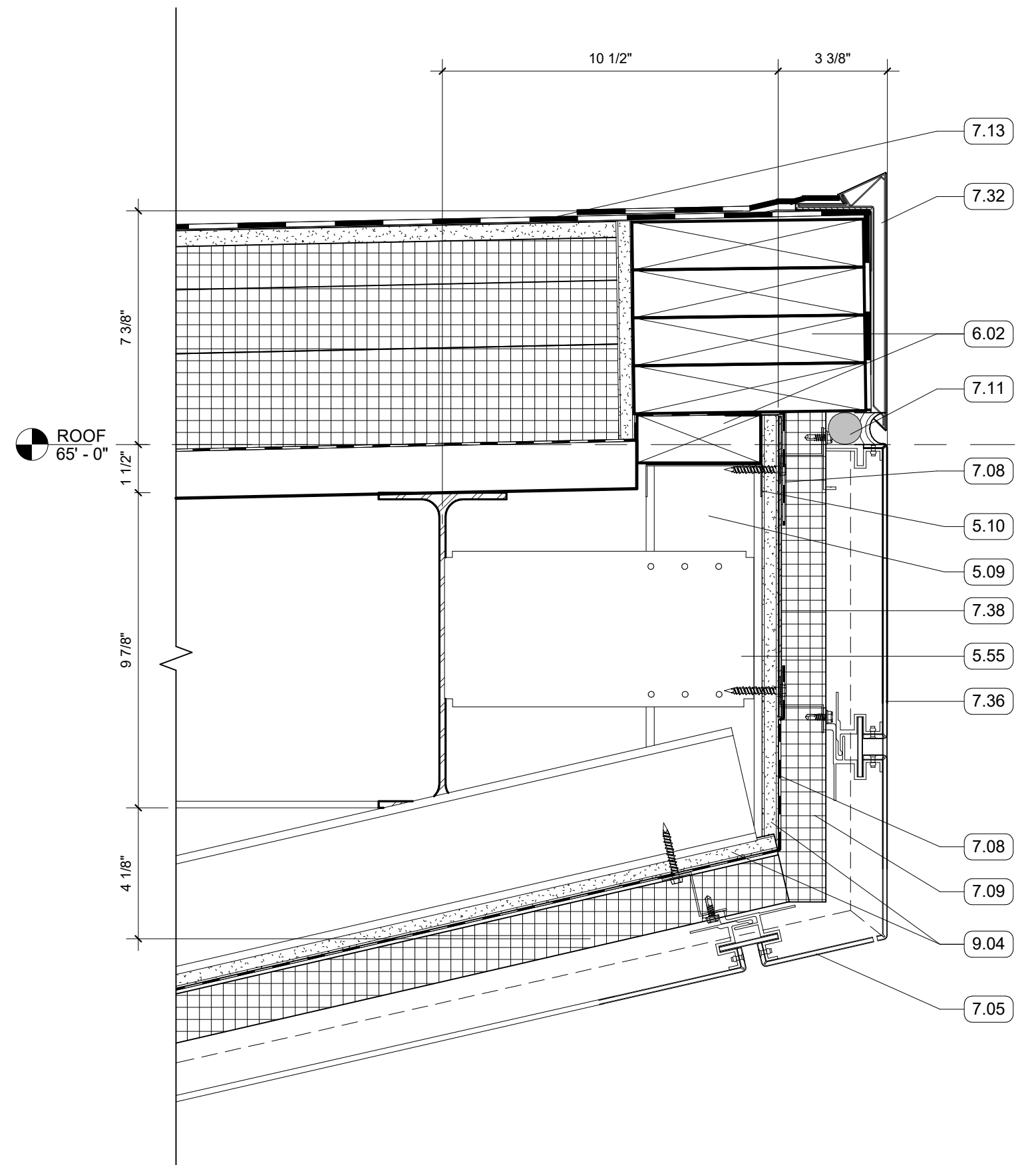

3 X2
3" = 1'-0" | RE:3/A352

19-602-23-01

