

5 ENLARGED STAIR PLAN - S202  
1/4" = 1'-0" | RE:1/A103

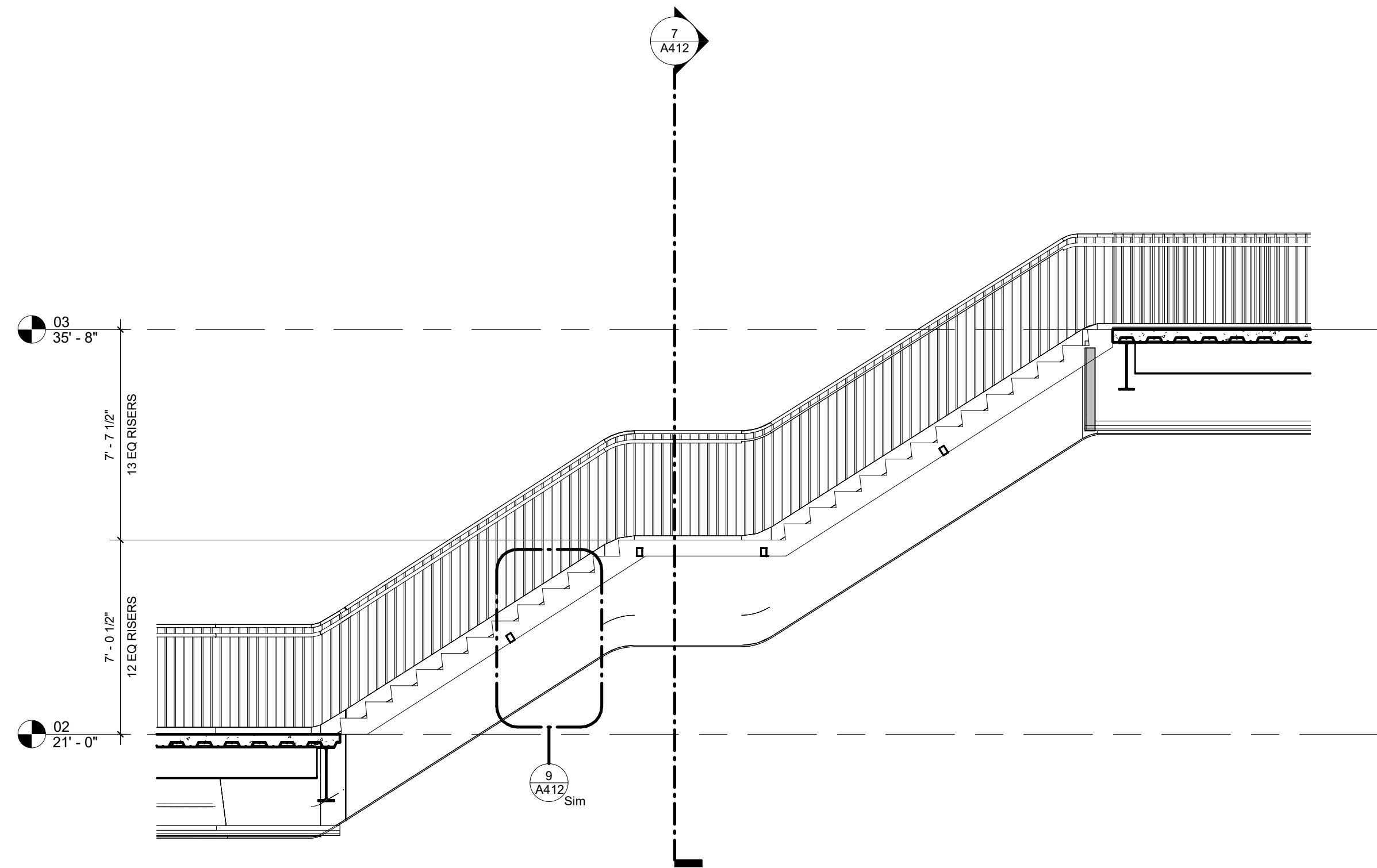

6 STAIR S202 SECTION  
1/4" = 1'-0" | RE:5/A412

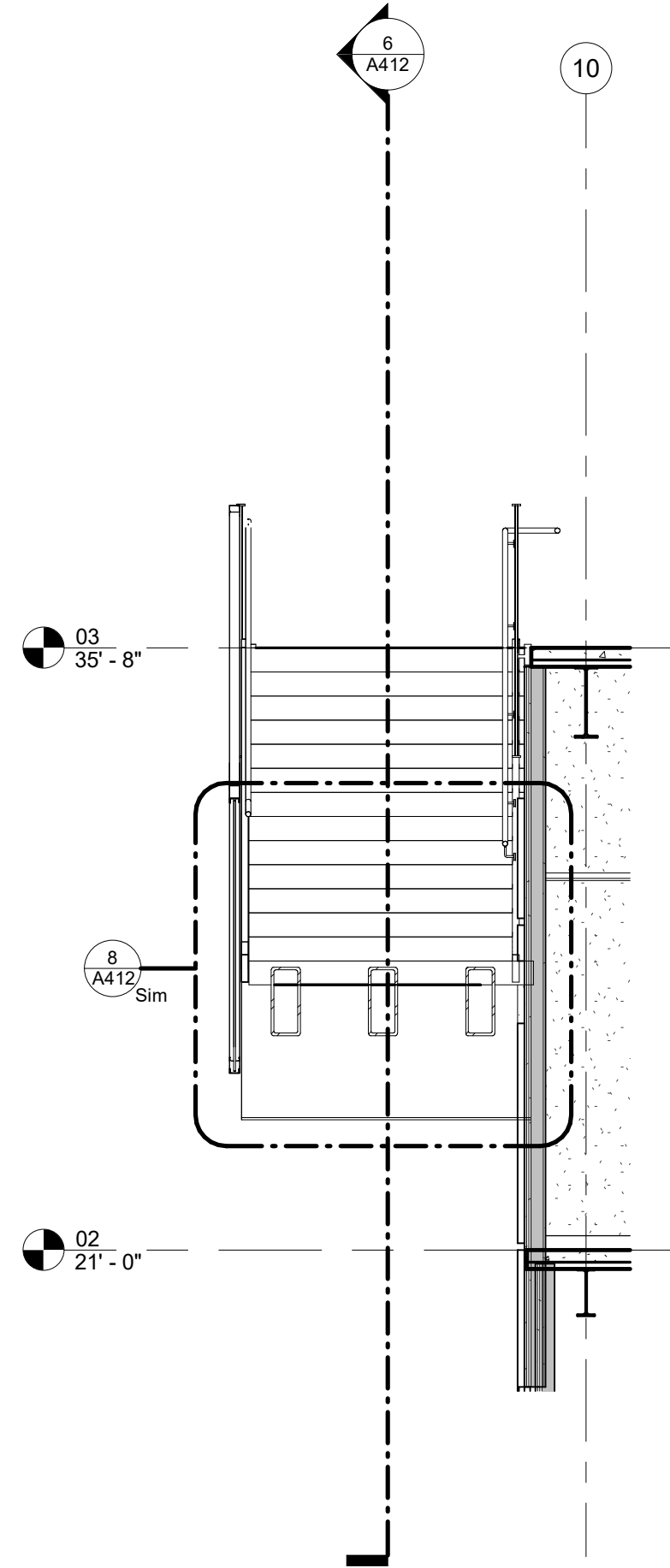

7 STAIR S202 SECTION  
1/4" = 1'-0" | RE:5/A412

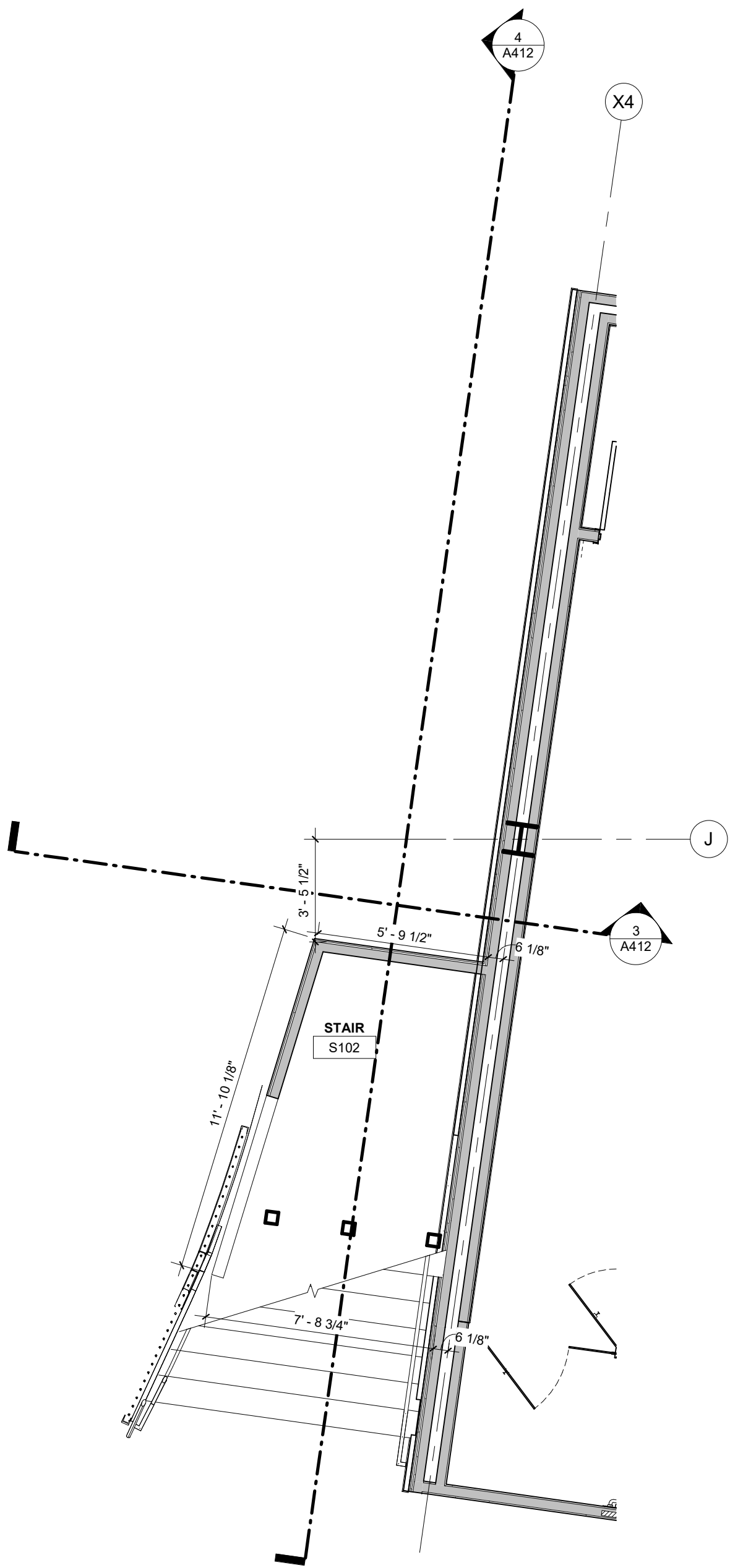

1 ENLARGED STAIR PLAN - S102  
1/4" = 1'-0" | RE:1/A101

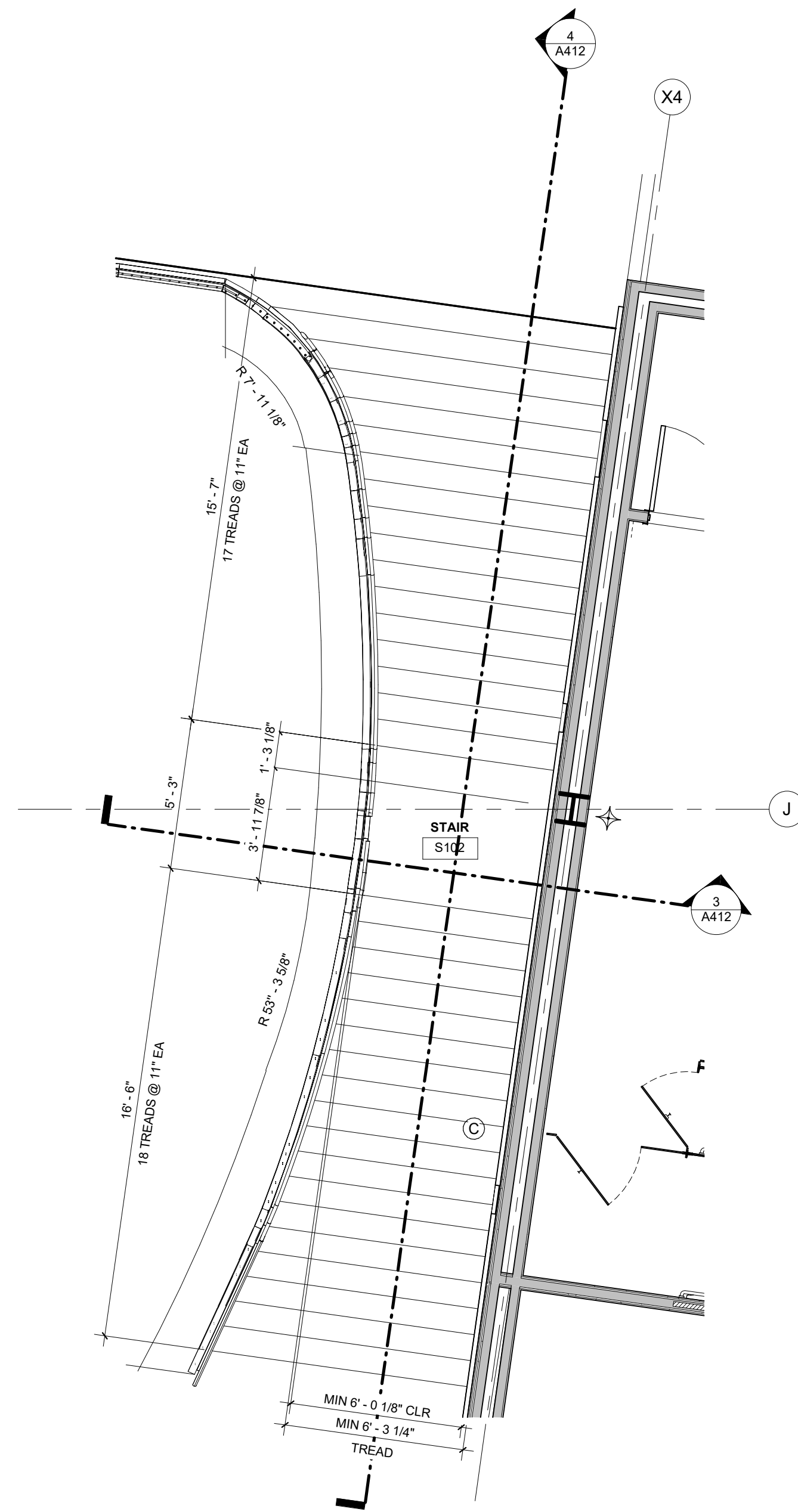

2 ENLARGED STAIR PLAN - S102  
1/4" = 1'-0" | RE:1/A102

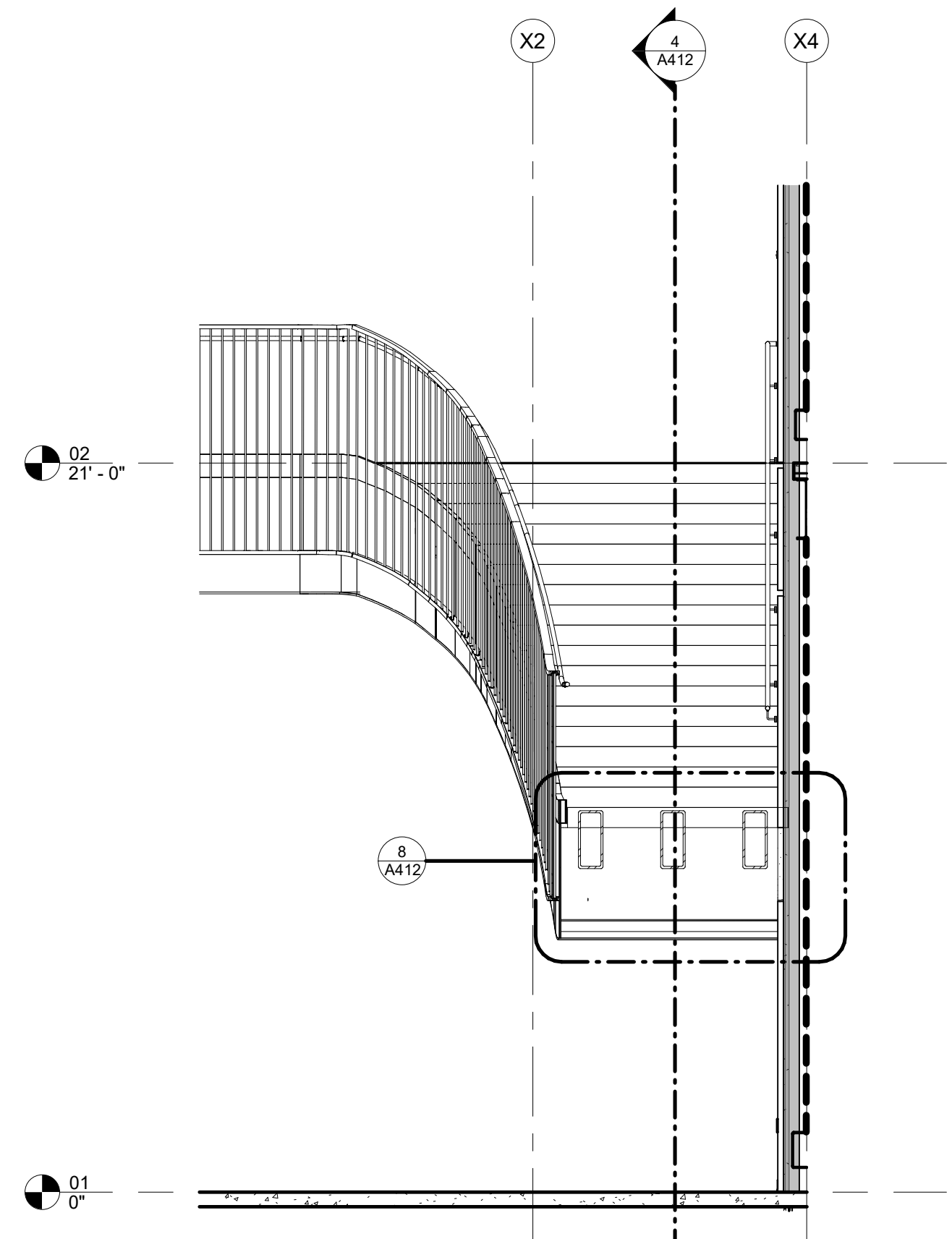

3 STAIR S102 SECTION  
1/4" = 1'-0" | RE:1/A412

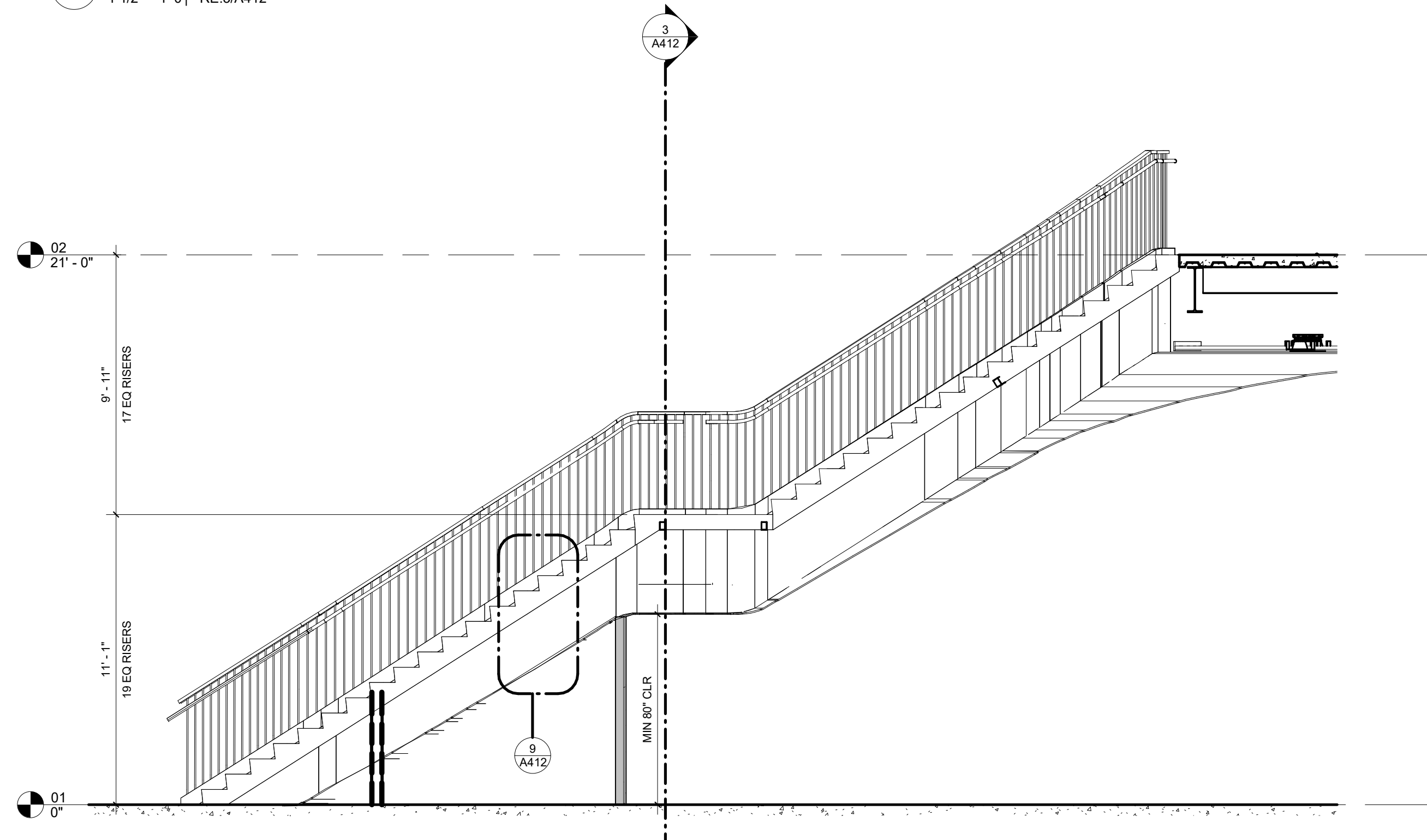

4 STAIR S102 SECTION  
1/4" = 1'-0" | RE:1/A412

9 SECTION DETAIL - STAIR TREADS AND RISERS  
1 1/2" = 1'-0" | RE:4/A412

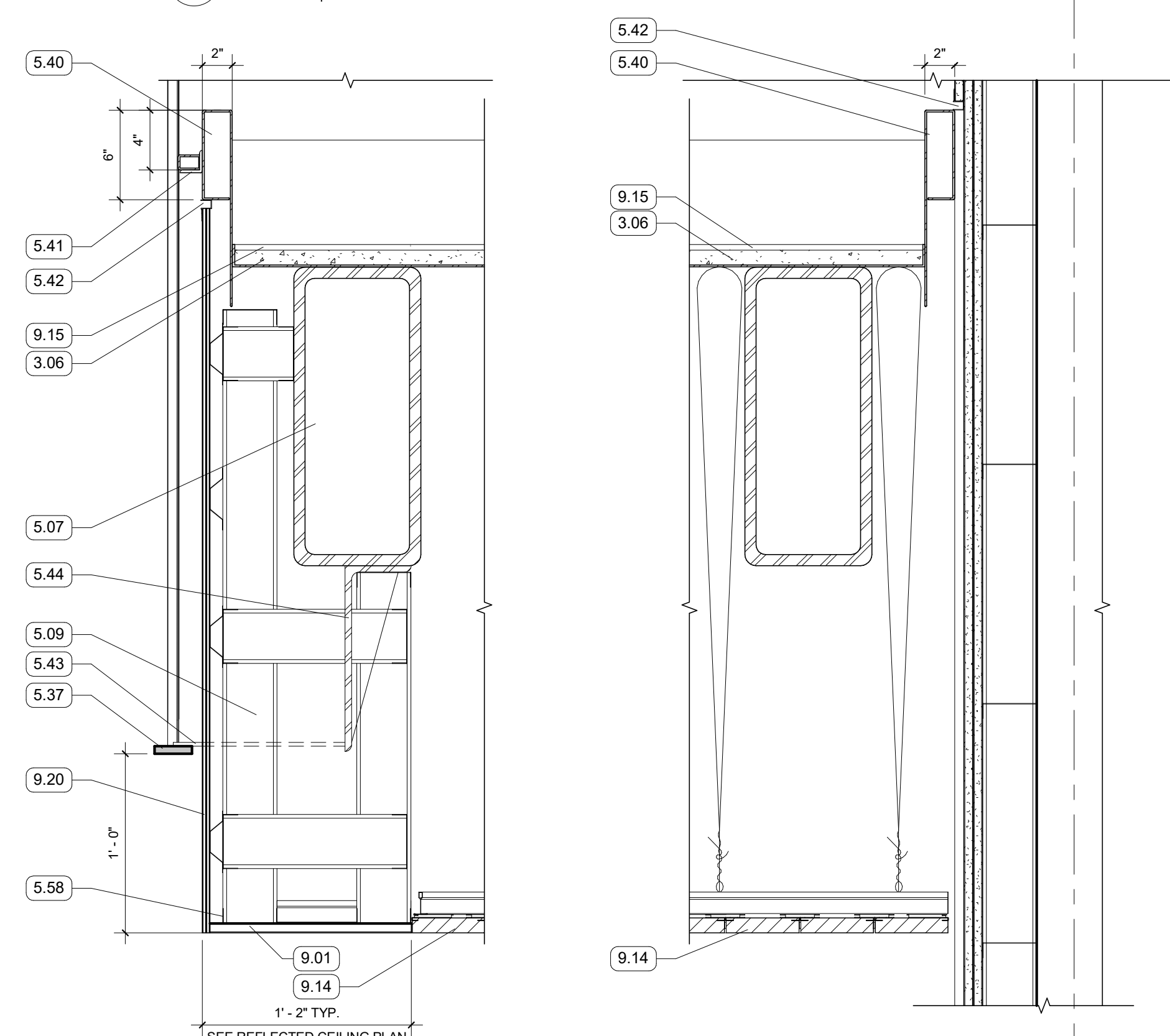

8 SECTION DETAIL - STAIR LANDING  
1 1/2" = 1'-0" | RE:3/A412

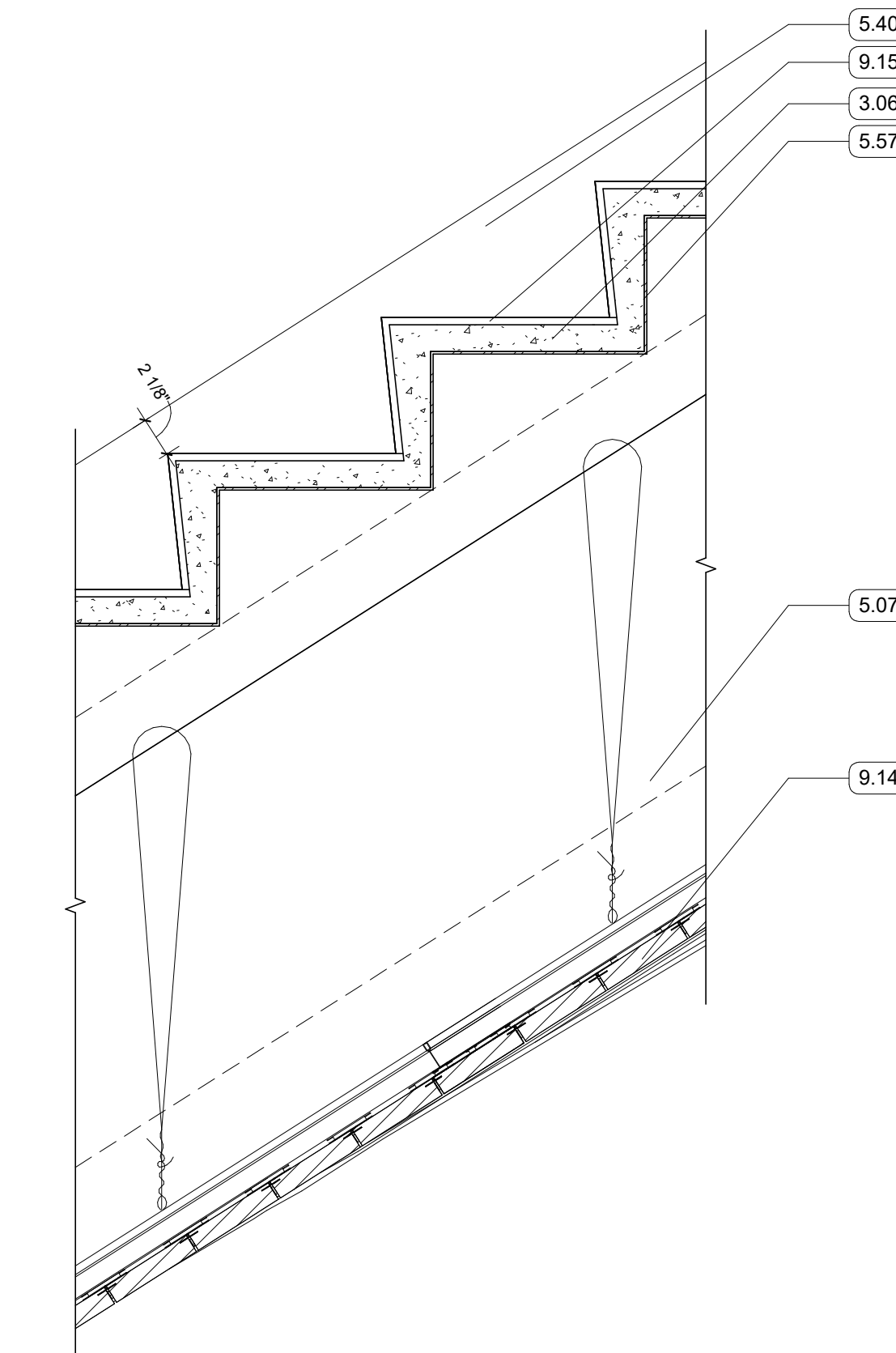

GENERAL NOTES

- KEYNOTES
- 3.06 PRECAST TERRAZZO TREAD, MIN 1"
  - 5.07 STRUCTURAL STEEL FRAMING
  - 5.09 3 5/8" METAL STUD FRAMING
  - 5.37 1/2" X 2 1/2" COLD-ROLLED PLATE STEEL WELDED TO RODS AT TOP AND BOTTOM OF RAILING, PAINTED
  - 5.40 2" X 6" COLD-STEEL TUBE WELDED TO POUR STOP, PAINTED
  - 5.41 1 1/2" X 1 1/2" X 1/4" COLD-ROLLED CLIP ANGLE, 2" WIDE, 27" O.C. WELDED TO STEEL TUBE, PAINTED
  - 5.42 ALUMINUM F-TRIM REVEAL
  - 5.43 1/4" COLD-ROLLED STEEL PLATE, 2" WIDE, 27" O.C. PAINTED
  - 5.44 BRACKET CONNECTION TO STEEL BEAM BY HANDRAIL SUPPLIER
  - 5.57 STEEL STAIR
  - 5.58 CURVED METAL TRACK
  - 9.01 5/8" GYPSUM BOARD; SEE FINISH PLAN FOR FINISH MATERIAL
  - 9.14 SUSPENDED WOOD CEILING SYSTEM
  - 9.15 TERRAZZO FLOORING
  - 9.20 (2) LAYERS 1/4" GYPSUM BOARD ON FURRING CHANNELS