

7 ENLARGED STAIR PLAN - S103
1/4" = 1'-0" | RE:1/A101

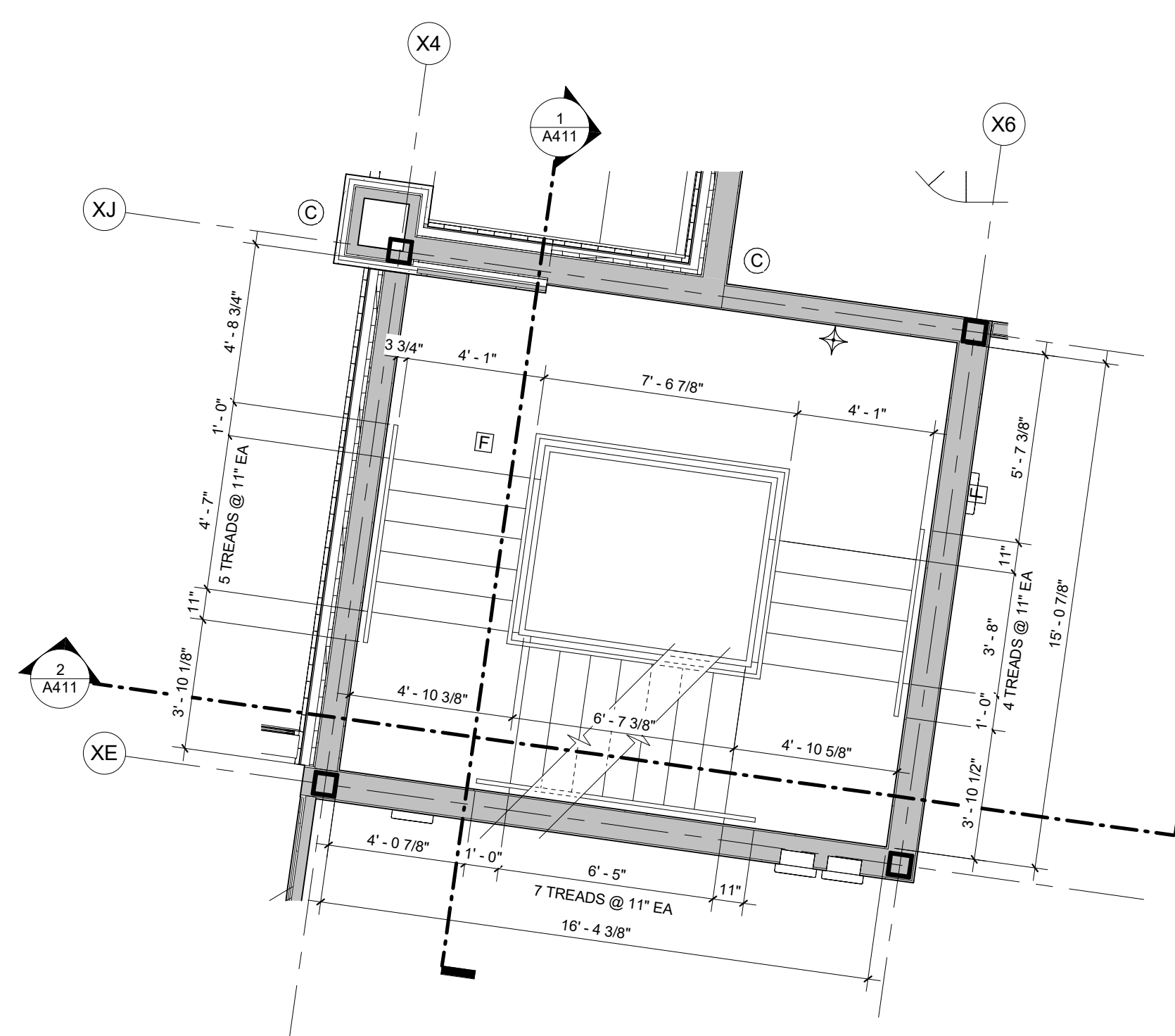

8 ENLARGED STAIR PLAN - S103 INT. LANDING
1/4" = 1'-0"

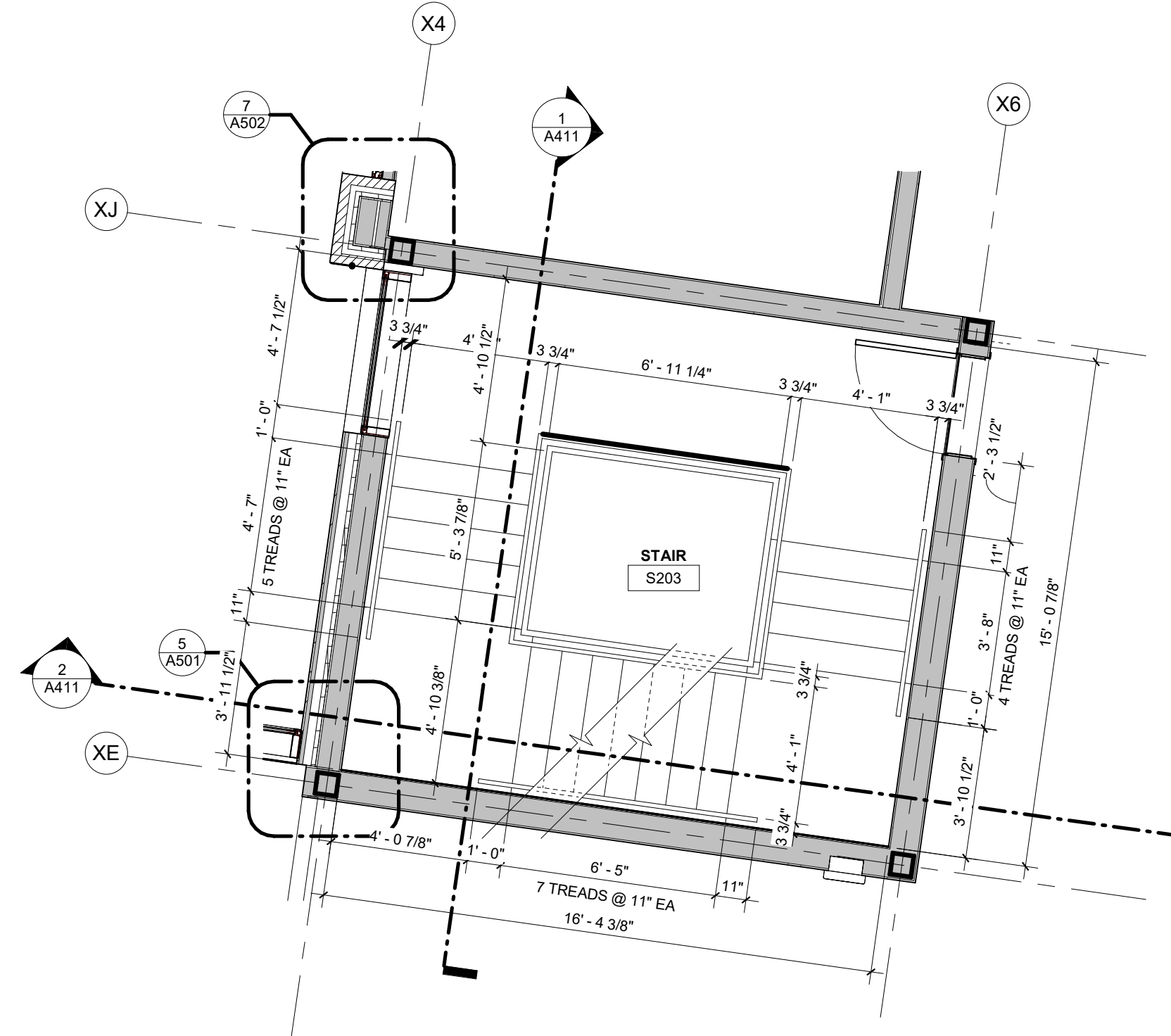

9 ENLARGED STAIR PLAN - S203
1/4" = 1'-0" | RE:1/A102

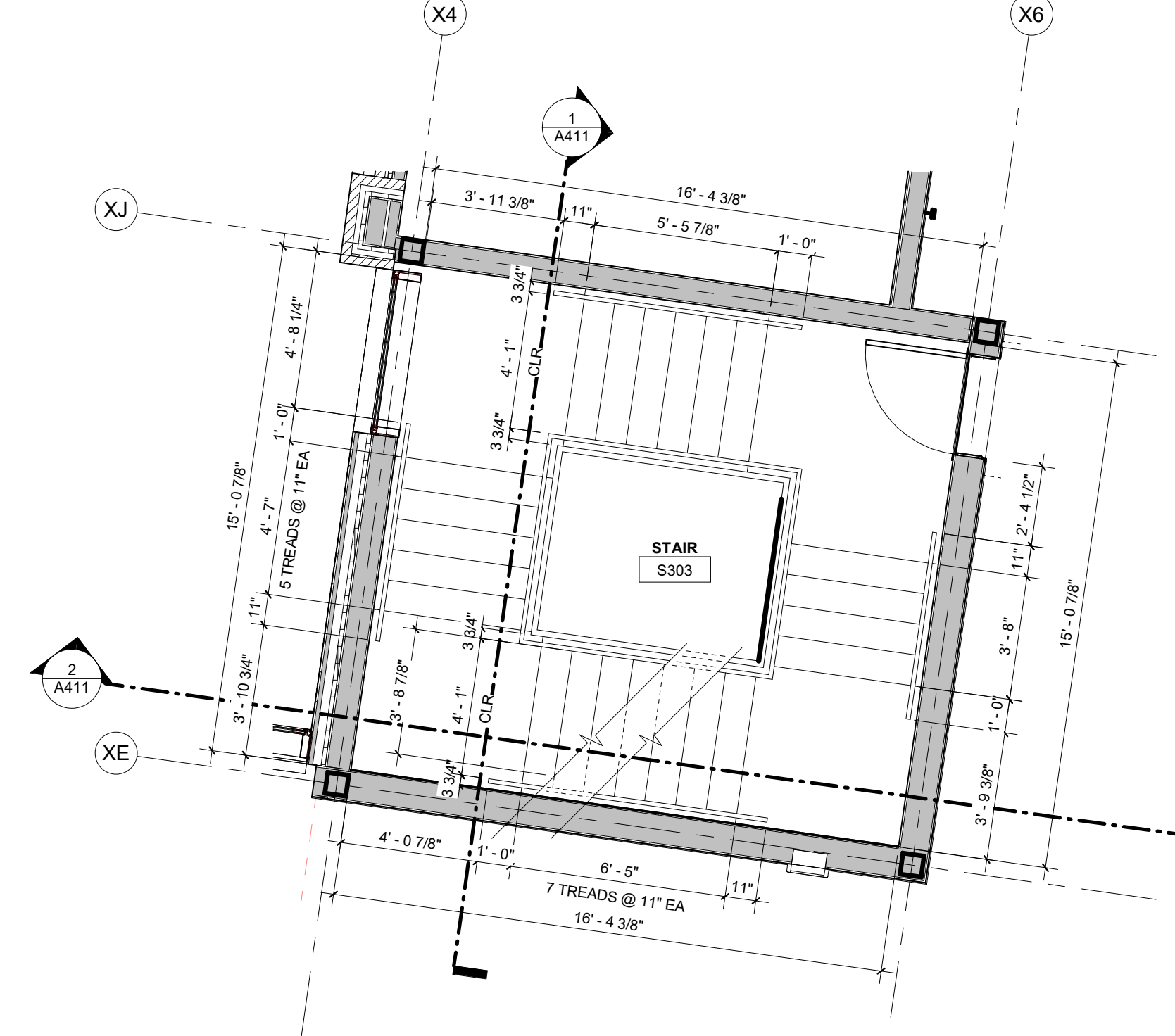

10 ENLARGED STAIR PLAN - S303
1/4" = 1'-0" | RE:1/A103

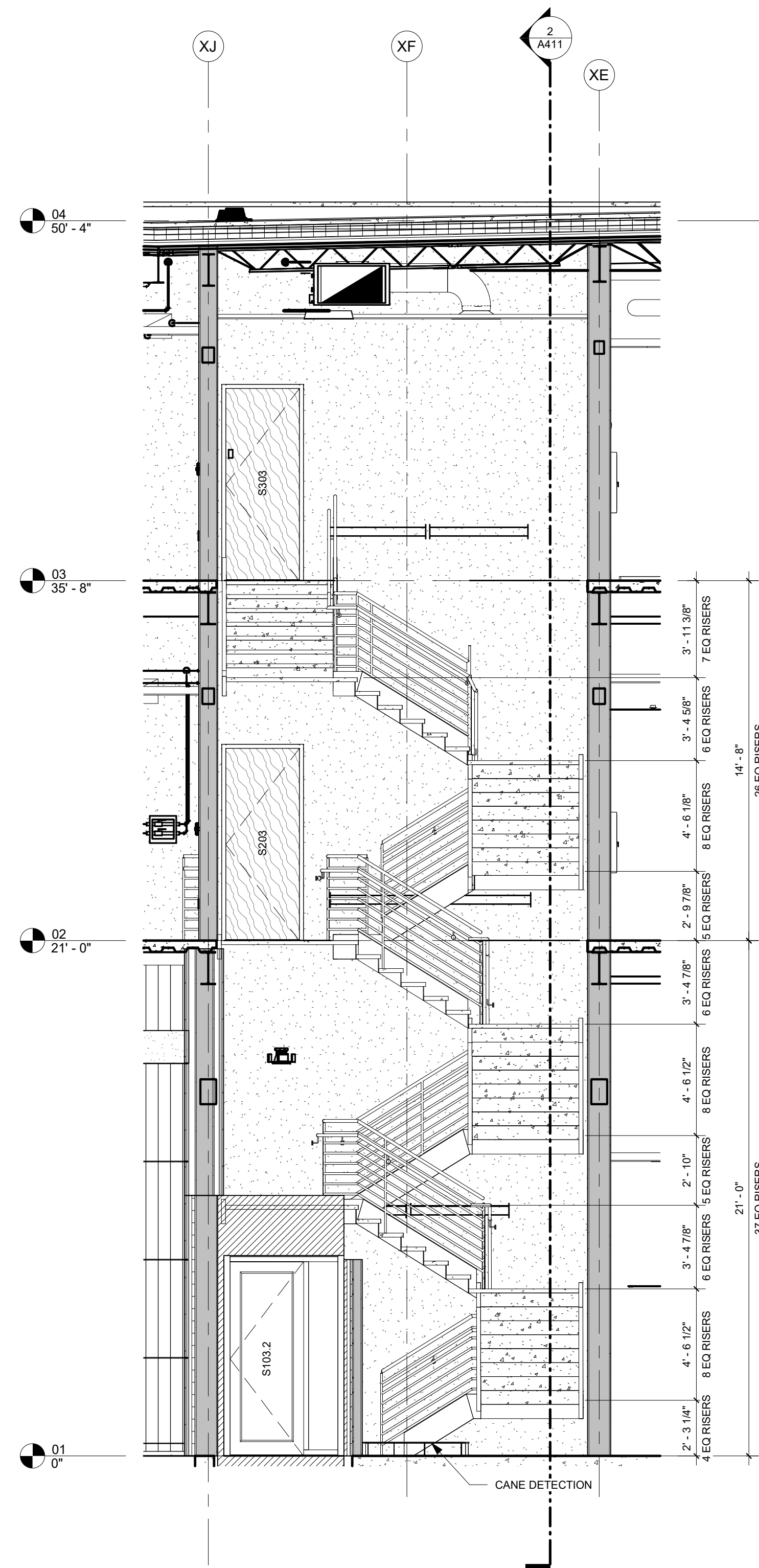

1 STAIR S103 SECTION 1
1/4" = 1'-0" | RE:2/A411

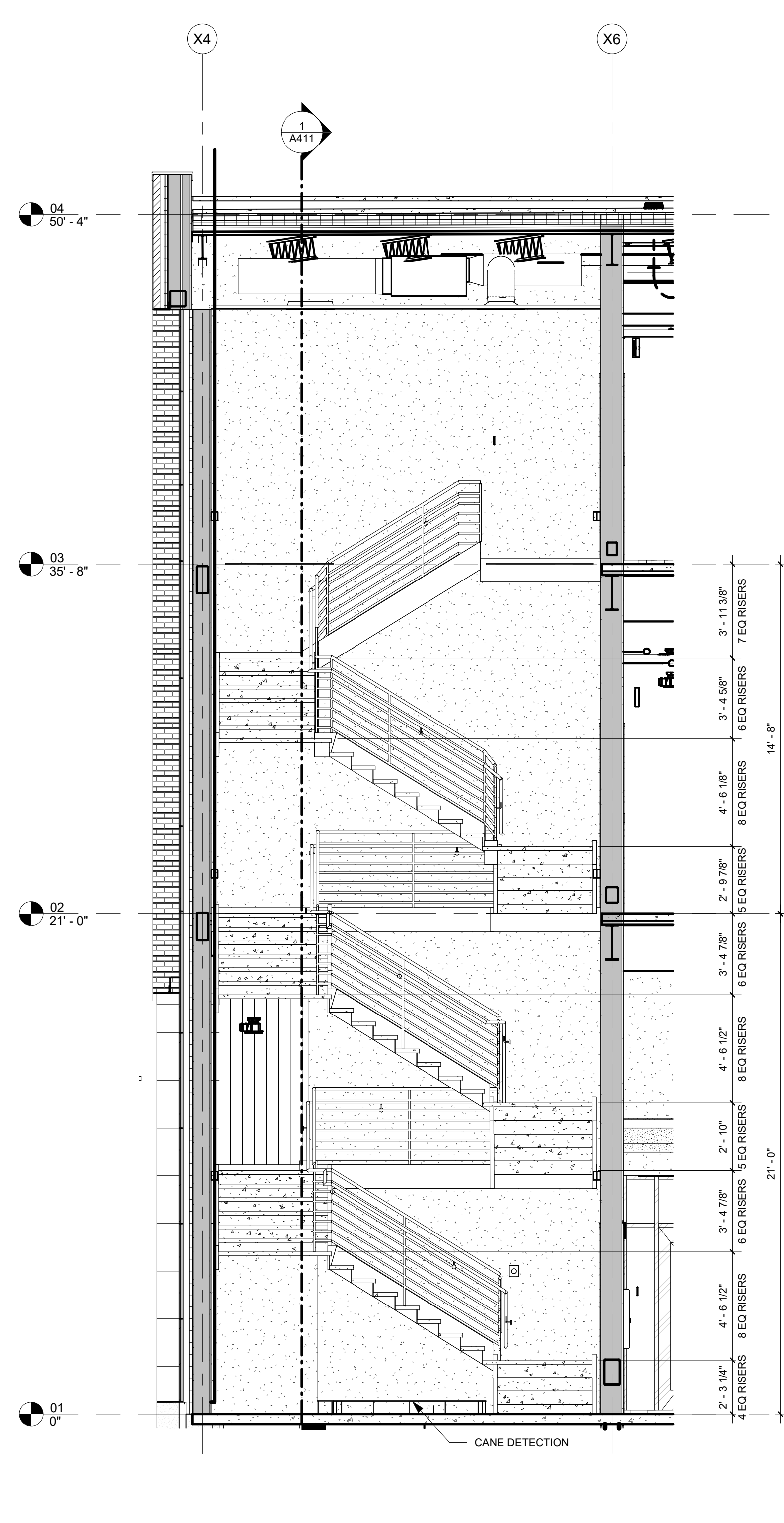

2 STAIR S103 SECTION 2
1/4" = 1'-0" | RE:1/A411

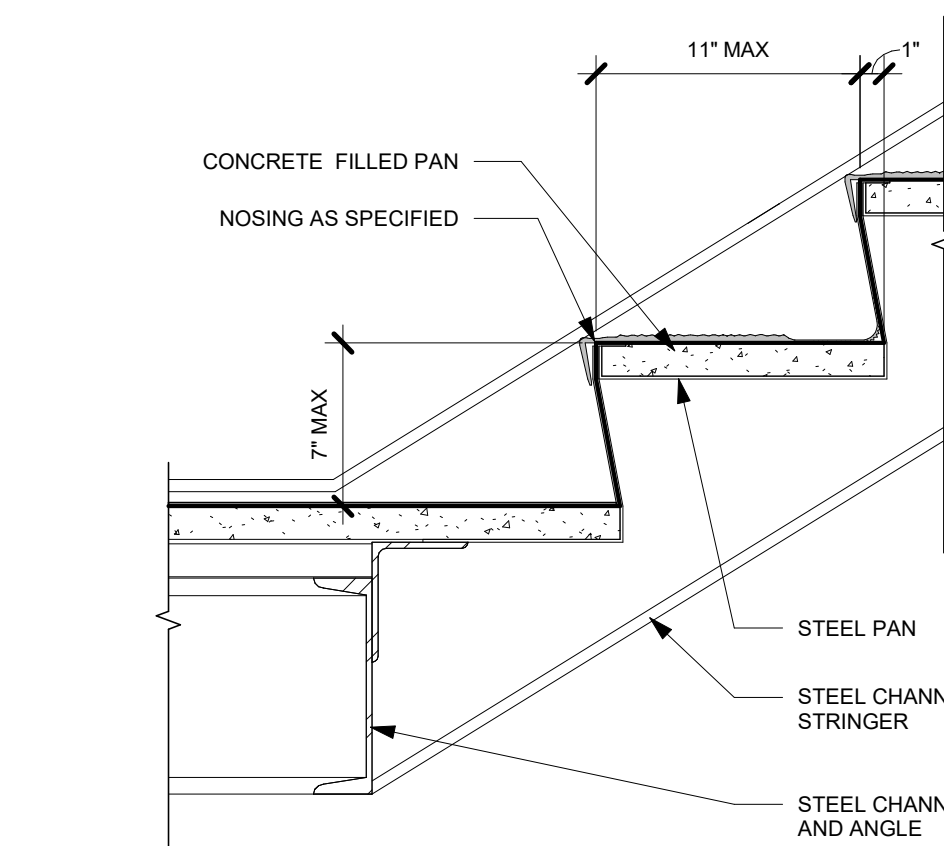

5 DETAIL METAL PAN STAIR LANDING TYP
1 1/2" = 1'-0"

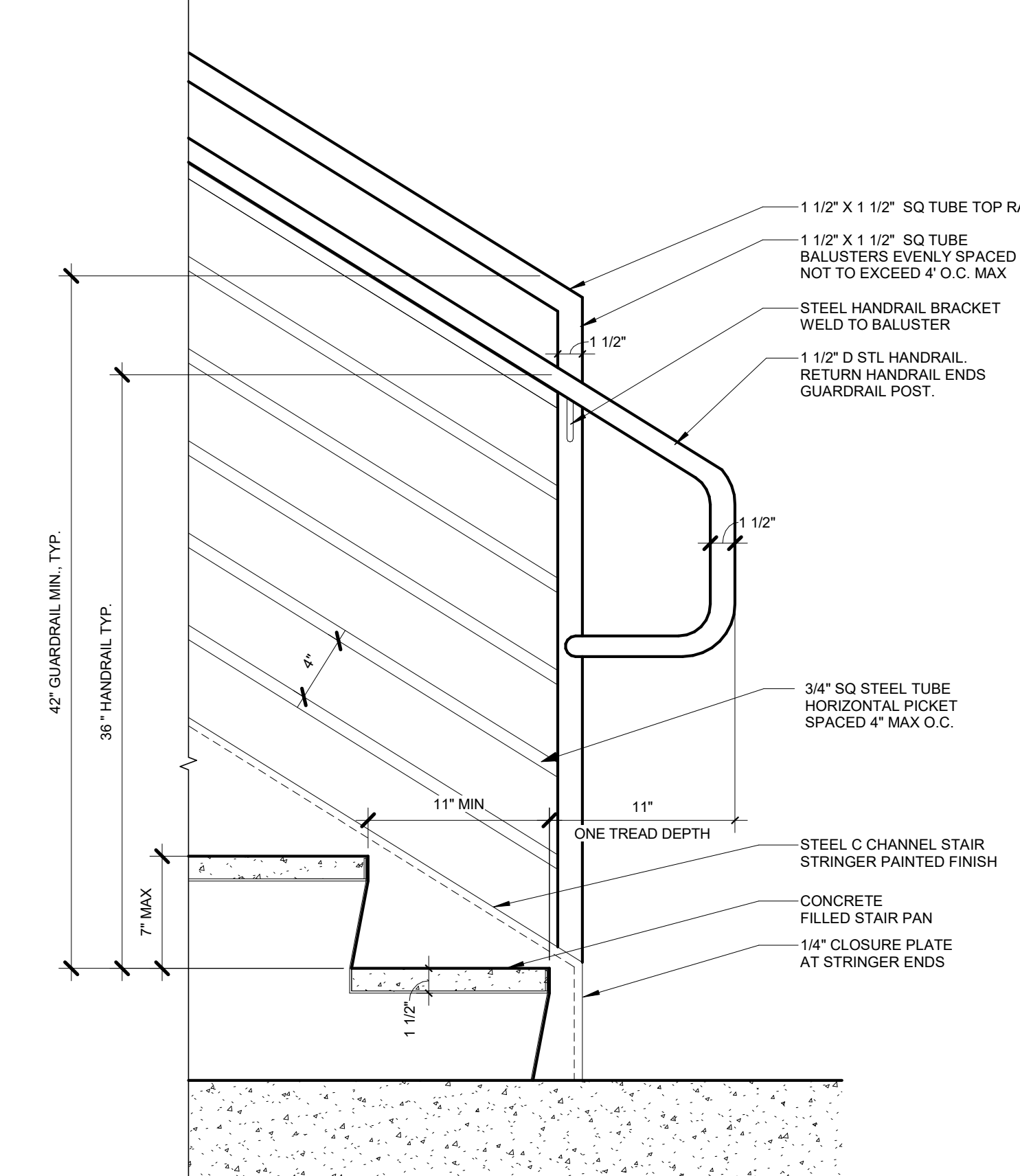

3 GUARDRAIL AT STAIR BASE
1 1/2" = 1'-0"

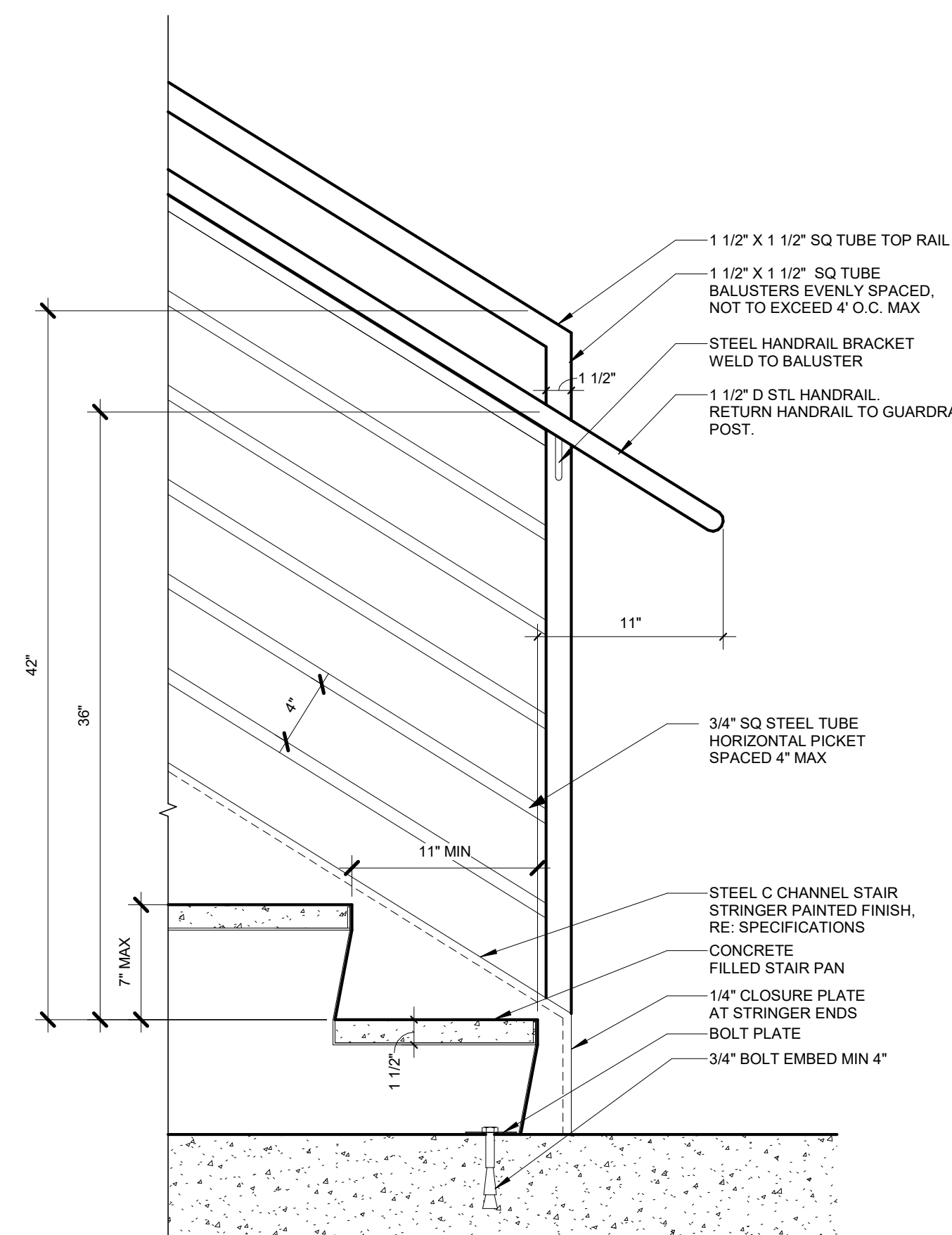

6 DETAIL GUARDRAIL HANDRAIL AT STAIR BASE TYP
1 1/2" = 1'-0"

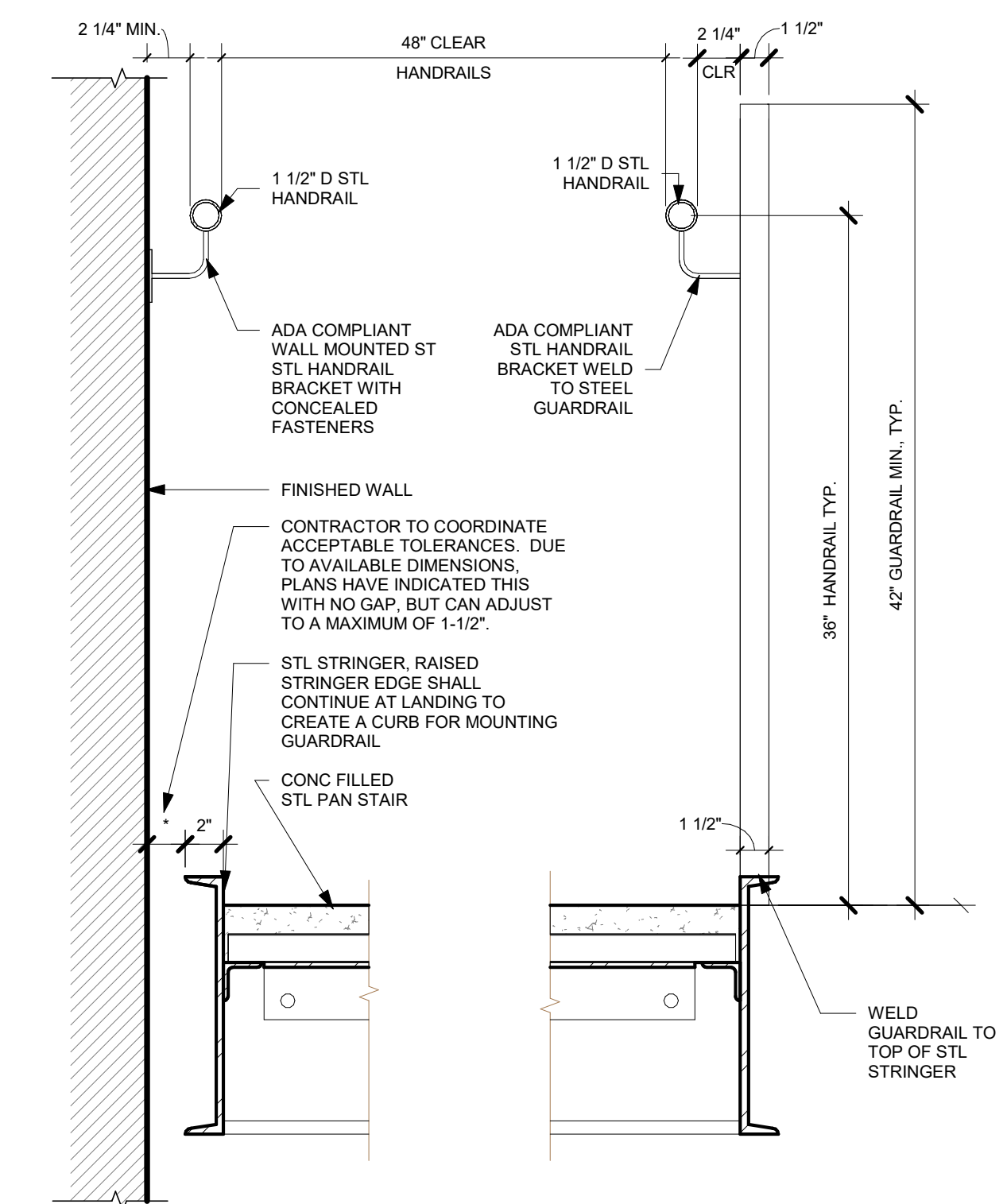

4 DETAIL GUARDRAIL HANDRAIL TYP
1 1/2" = 1'-0"