

KEYNOTES
7.05 MCM PANEL SOFFIT
10.05 EXTERIOR DIMENSIONAL LOGO SIGNAGE

CONSULTANTS
Monsieur & Associates, LLC
CABDO Landscape Architecture, LLC
Fox Nease Engineering, LLC
Sela O'Brien
Mechanical Engineering
Associated Design Group, Inc.
Electrical Engineering
Specialty Architecture

ISSUE FOR BID
LOUISIANA STATE UNIVERSITY
ALEXANDRIA
DOWNTOWN HEALTH SERVICES CENTER
800 JACKSON ST.
ALEXANDRIA, LA 71301

PROJECT # 19-602-23-01
ARCH PROJECT # 2023.20 / 1531.00-23
SITE ID: NEW SITE CODE: 4-40-023
DATE OCTOBER 10, 2023

Ashe Broussard Weinzettle Architects, LLP
Tipton Associates APAC, A Joint Venture
301 Jackson Street, Suite 205
Alexandria, LA 71301

NO. REVISION DATE

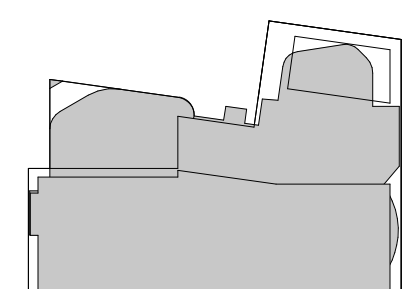
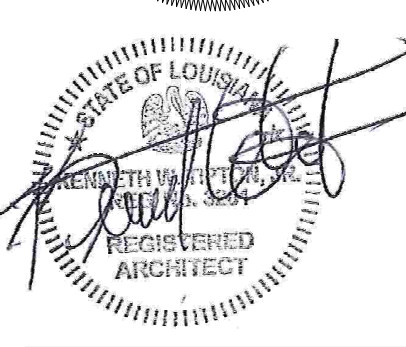
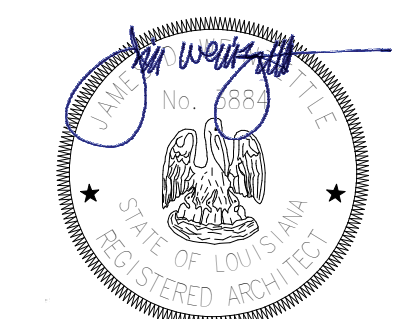

FOURTH FLOOR
REFLECTED
CEILING PLAN

A114

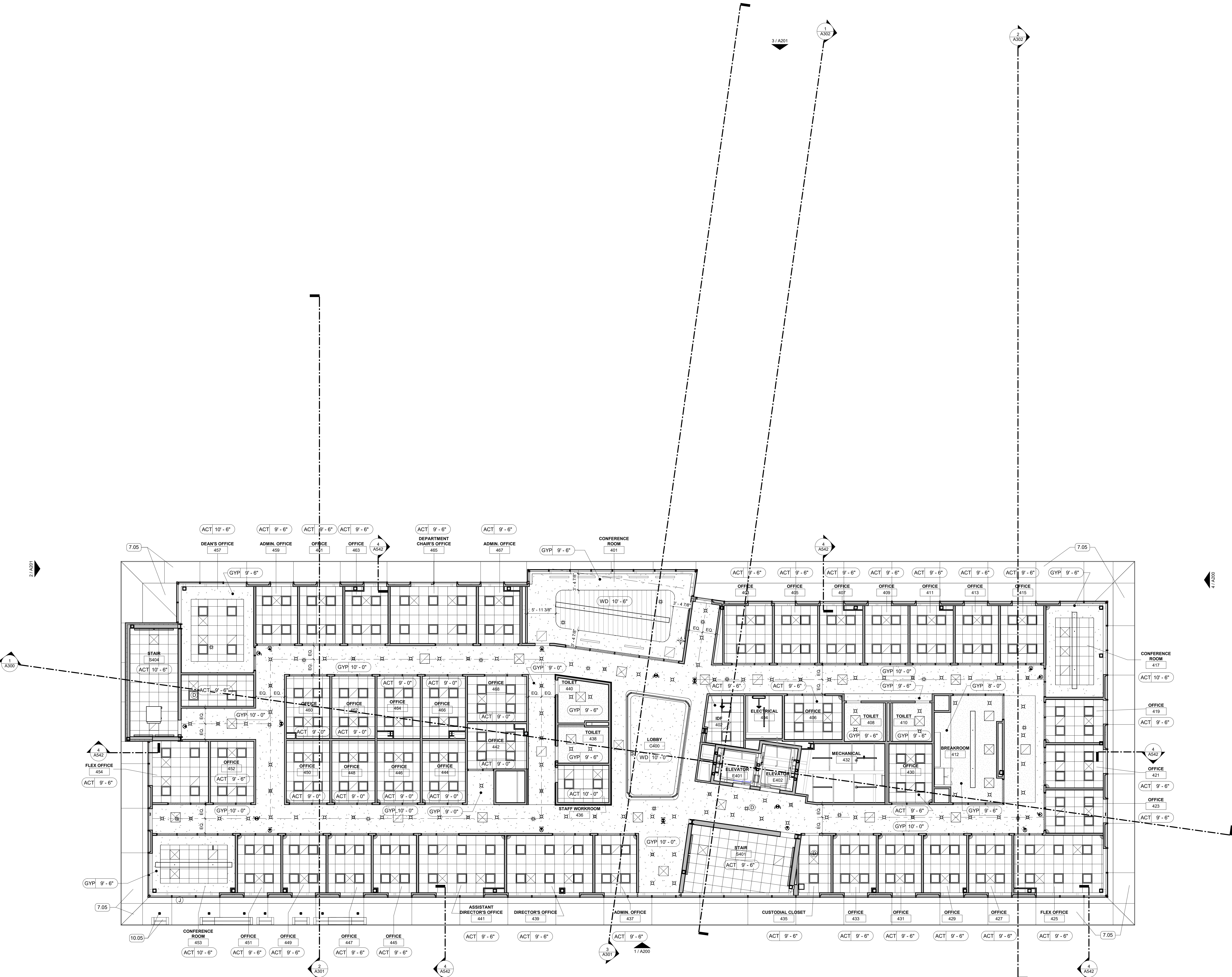

LEGEND

- | | | | |
|--|--------------------------------------|--|---|
| | 2' x 2' SUSPENDED ACOUSTICAL CEILING | | 2' x 2' LIGHT FIXTURE, RE: ELEC |
| | 2' x 4' SUSPENDED ACOUSTICAL CEILING | | SURFACE MOUNTED LIGHT FIXTURE, RE: ELEC |
| | PAINTED DRYWALL CEILING | | RECESSED DOWNLIGHT, RE: ELEC |
| | WOOD VENEER ACOUSTICAL CEILING | | EMERGENCY LIGHT, RE: ELEC |
| | SUPPLY AIR DIFFUSER, RE: MECH | | CEILING SENSOR, RE: ELEC |
| | RETURN AIR GRILLE, RE: MECH | | EXIT SIGN LIGHT FIXTURE, RE: ELEC |
| | SMOKE DETECTOR, RE: ELEC | | |

1 FOURTH FLOOR REFLECTED CEILING PLAN
1/8" = 1'-0" | RE: 1/A200