

KEYNOTES  
10.09 CEILING-MOUNTED CURTAIN TRACK AND  
PRIVACY CURTAIN

CONSULTANTS  
Monsieur & Associates, LLC  
CABDO Landscape Architecture, LLC  
Fox Nease Engineering, LLC  
S&S O'Brien  
Associated Design Group, Inc.  
Specialty Architecture

ISSUE FOR BID  
LOUISIANA STATE UNIVERSITY  
ALEXANDRIA  
DOWNTOWN HEALTH SERVICES CENTER  
800 JACKSON ST.  
ALEXANDRIA, LA 71301

PROJECT # 19-602-23-01  
ARCH PROJECT # 2023.20 / 101160-23  
SITE ID: NEW SITE CODE: 4-40423  
DATE OCTOBER 10, 2023

Ashe Broussard Weinzettle Architects, LLP  
Tipton Associates APAC, A Joint Venture  
301 Jackson Street, Suite 205  
Alexandria, LA 71301

NO.	REVISION	DATE

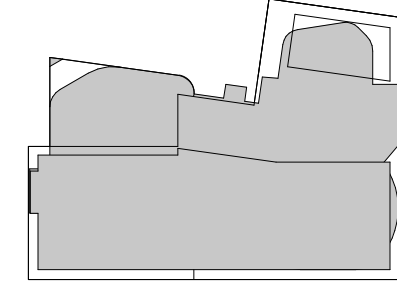
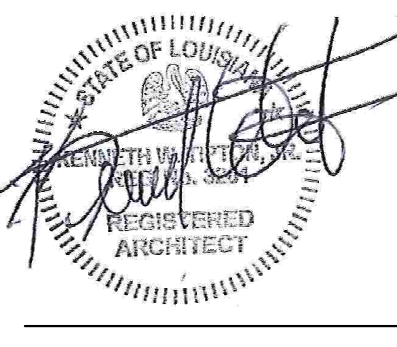
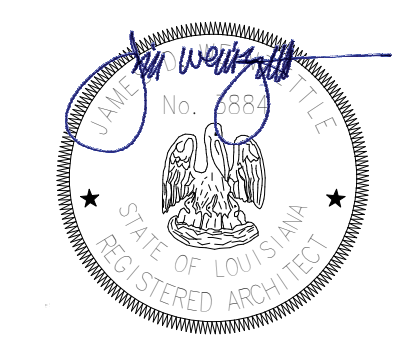

SECOND FLOOR  
REFLECTED  
CEILING PLAN

A112

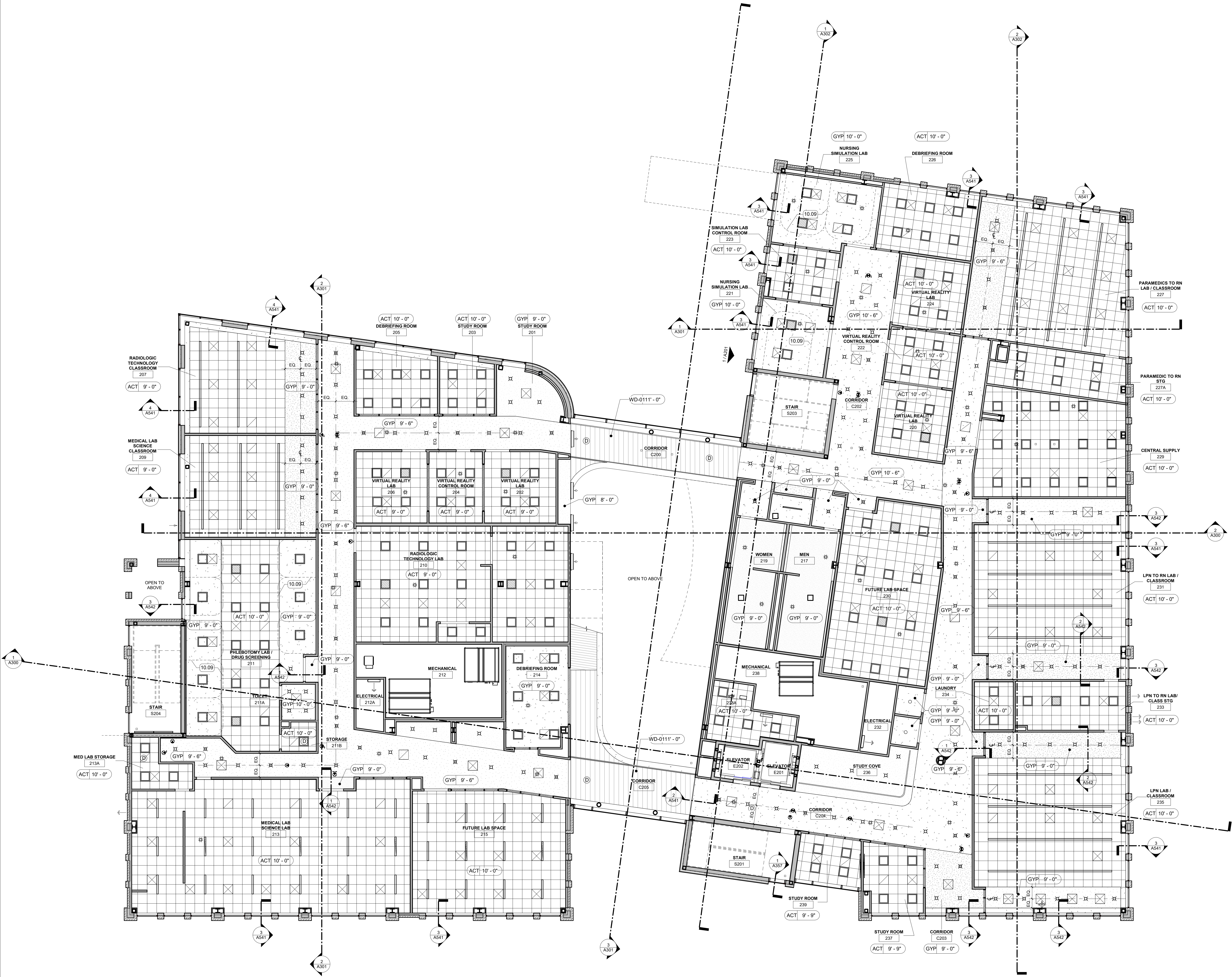

- LEGEND
- |                                      |   |
|--------------------------------------|---|
| 2' x 2' SUSPENDED ACOUSTICAL CEILING | 2' x 2' LIGHT FIXTURE, RE: ELEC         |
| 2' x 4' SUSPENDED ACOUSTICAL CEILING | SURFACE MOUNTED LIGHT FIXTURE, RE: ELEC |
| PAINTED DRYWALL CEILING              | RECESSED DOWNLIGHT, RE: ELEC            |
| WOOD VENEER ACOUSTICAL CEILING       | EMERGENCY LIGHT, RE: ELEC               |
| SUPPLY AIR DIFFUSER, RE: MECH        | CEILING SENSOR, RE: ELEC                |
| RETURN AIR GRILLE, RE: MECH          | EXIT SIGN LIGHT FIXTURE, RE: ELEC       |
| SMOKE DETECTOR, RE: ELEC             |   |

1 SECOND FLOOR REFLECTED CEILING PLAN  
1/8" = 1'-0" | RE:1/A200